

# Industrial Powder Coating Equipment & Automated Line Solutions

Sales brochure

Modern systems for faster color changes, stable finish quality, compact layouts and worldwide project support.

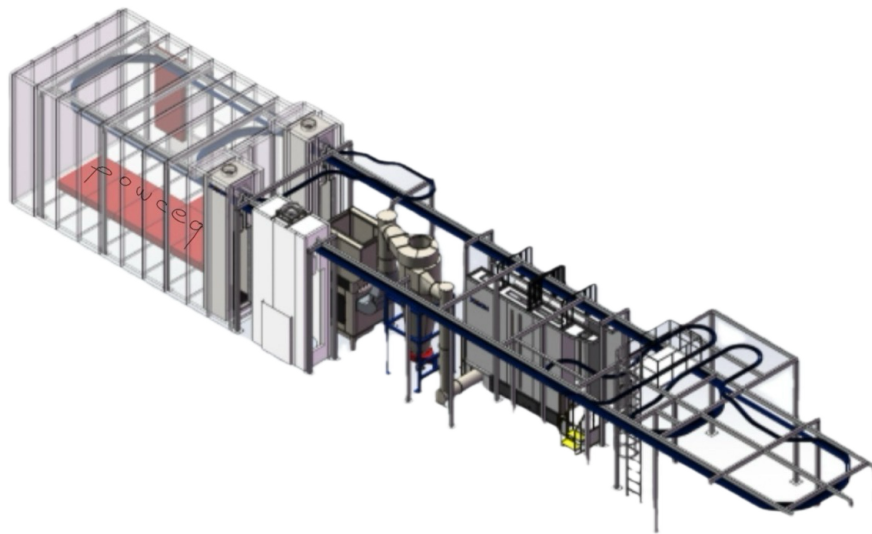

**Turnkey powder coating plants, ovens, booths, powder centers and pretreatment lines**

**Compact layouts built for higher output in less space**

**Fast quote process with tailored equipment guidance**

[powceq.com](http://powceq.com)

# Why manufacturers choose Powceq

The homepage positions Powceq as a supplier of complete industrial powder coating solutions - from compact manual setups to fully automated lines. The strongest commercial messages are faster delivery, tailored system design, worldwide support and practical equipment bundles that help buyers move from inquiry to offer quickly.



## Fast color change booth

Built for higher uptime and shorter changeover cycles, supporting more productive daily operation.

## Commercial highlights

- Faster color changes
- Cleaner operation
- Stable production flow
- Strong fit for modern automated lines

### Tailored line concepts

System combinations for ovens, booths, powder centers, conveyors and pretreatment.

### Shorter project path

A commercial structure focused on fast quotes, info sheets, offers and technical guidance.

### Global sales footprint

Positioned for buyers in Europe, GCC, USA and other international markets.

# Featured product portfolio

A sales-ready overview of the main equipment categories presented on the homepage.



### Powder feed centers

Multiple feed center variations aimed at cleaner color changes, lower powder consumption and efficient daily operation.



### Transfer pumps and PLC-controlled systems

Modern powder delivery with stable flow, practical mobility and intelligent control options.



### Curing ovens

Batch and continuous curing concepts designed for uniform heat transfer, throughput and reliable finish quality.

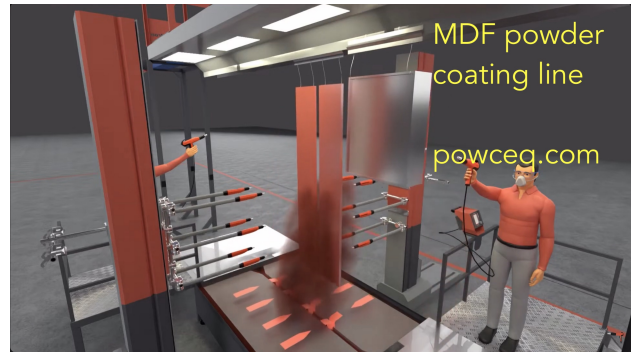

### MDF powder coating lines

Specialized equipment concepts for MDF board and other heat-sensitive substrates.

## Complete lines, not just components

The homepage consistently sells the broader value: a complete coating operation that links pretreatment, booths, powder handling, curing and automation in one coherent system.

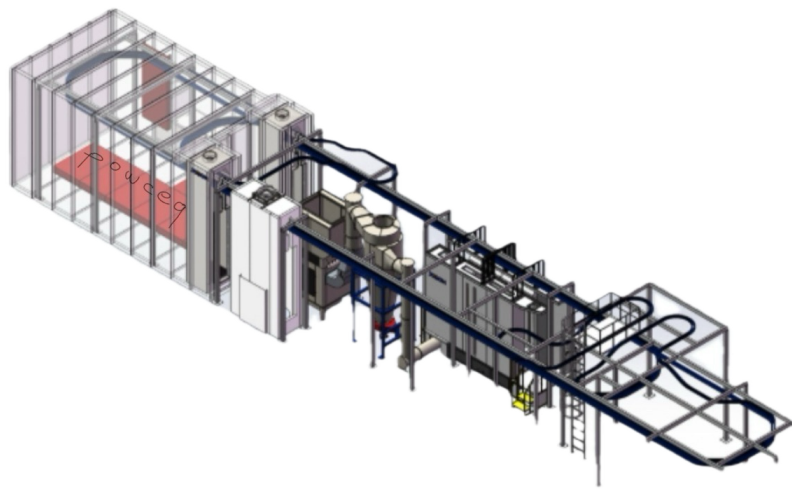

Before coating	During coating	After coating
Pretreatment lines Washers and dryers	Manual or automatic booths Powder centers and pumps Spray technology	Curing ovens Conveyors Project integration

## Ready to quote your next powder coating project?

Powceq presents itself as a fast-response supplier for industrial buyers looking for equipment recommendations, offers and project support. Use the site to request a tailored quote and match the right system to your required throughput, layout and finish quality goals.

Website: [www.powceq.com](http://www.powceq.com)